



VT Hackney

A company of VT Systems



Model LRC-0758-60 Light Rescue

Hackney

Sourcewell 
Formerly NJPA

Awarded Contract

#022818-VTH

LRC-0758-60

Hackney Emergency Vehicles

NJPA - HACKNEY LRC0758 - 60

Sales Rep:

Terms:

Drawing #:

Est. Delivery Date: / /

Customer PO #:

Penalty:

Customer #:

QPF #:

Exp. Date: 02/10/2018

Quote No: NJPA LRC0758 - 60-0004

BODY: XLRC100 NJPA LRC0758-60 LIGHT RESCUE

08/17/2018

Page 1

PART NO	DESCRIPTION	QTY
== NJPA LRC0758-60 LIGHT RESCUE - ==		1
== QW RELEASE - Effective 01-02-18 ==		1
CAB and CHASSIS		1
10-04-5201	FORD F-550 - 2-DR/2WD - 60"CA	1
10-19-1025	"MUST BE SEATED AND BELTED" - WARNING PLATE	1
10-19-1045	WARNING PLATE - VEHICLE SPECIFICATION DATA	1
10-19-1075	"DO NOT WEAR HELMET WHILE SEATED" - WARNING PLATE	1
10-99-2510	EXHAUST PIPE EXTENSION - FORD SUPER-DUTY	1
11-16-0220	BATTERY CONDITIONER - PROGRESSIVE DYNAMICS	1
11-17-0020	SHOREPOWER INLET, 20 AMP W/COVER & FEMALE PLU	1
11-33-0802	GROUND LIGHTS - TECNIQ LED - FRONT CAB DOOR (PR)	1
12-00-1000	MUD FLAPS, FRT (PR) BLACK RUBBER	1
12-57-0021	TIRE PRESSURE MONITORING - REALWHEELS AIRSECURE - 6-WHL	1
16-10-1510	TOW EYE PLATES - REAR - BLACK (PR)	1
BODY and FRAME OPTIONS		1
20-00-3000	FRAME MODIFICATION - LR/PL	1
20-01-0000	BODY CONSTRUCTION - LIGHT RESCUE	1
20-11-1360	BODY - LIGHT RESCUE - LRC0758 COMMANDER 60" CA	1
20-62-7301	SHUTTER DOOR SILL PLATE (7) - LRC - Optional	1
20-62-7321	SHUTTER DOOR DRIP PAN (7) - Stainless Steel (Optional)	1
20-71-0010	WHEELHOUSING SKIRT PANEL - BRIGHT ALUMINUM TREADPLATE	1
20-71-0120	FRONT BODY PANEL - PAINTED	1
20-71-0210	REAR KICK PANEL - LR MODELS (Optional)	1
20-71-0330	FENDERETTES, STAINLESS STEEL (PR) - COMMANDER	1

PART NO	DESCRIPTION	QTY
20-72-2002	FUEL/DEF FILLER W/HINGED ACCESS DOOR - F450/550 only	1
20-72-3000	ULTRA-LOW SULFUR DIESEL FUEL ONLY LABEL	1
20-72-3100	DEF FLUID LABEL	1
EXTERIOR BODY OPTIONS		1
22-21-0000	STONE GUARDS, FRT & REAR - D/P CORNERS (4)	1
22-25-2000	BUMPER, REAR STEP BRIGHT TREAD PLATE	1
22-25-5500	SIGN - "DANGER - DO NOT RIDE ON REAR STEP"	1
22-40-3000	WHEEL CHOCK - ZICO AC-2 (EA)	2
22-40-3105	WHEEL CHOCK BRACKET - HORIZONTAL FOR ZICO AC-2 (EA)	2
22-50-3010	LICENSE PLATE INSERTS & LIGHT	1
22-51-1000	MUD FLAPS, REAR (PR) BLACK RUBBER	1
INTERIOR BODY OPTIONS		1
23-11-0505	UNISTRUT "C" CHANNEL (set of 4) - up to 30"L	5
23-11-0506	UNISTRUT "C" CHANNEL (set of 4) - up to 50"L	2
23-11-2101	SHELF - EXTENDED FLOOR - PERMANENT (EA)	2
EXTERIOR BODY OPTIONS		1
PAINT and GRAPHICS		1
40-00-0009	PAINT BODY - LIGHT COMMANDER RESCUE - ONE COLOR	1
41-00-0000	DO NOT RE-PAINT CAB	1
42-12-0000	TOUCH UP PAINT - ONE QUART	1
42-90-0500	COMPARTMENT WALLS/FLOORS COATING - MULTISPEC (ea. comp't)	7
42-99-0000	UNDERCOATING CAB, FRAME & BODY	1
43-20-2000	STRIPE, REFLECTIVE 4" PRICE PER FOOT REQS DWG	30
43-20-8005	CHEVRON STRIPE - REAR BODY W/NO REAR DOOR - LIGHT RESCUE	1
43-20-8120	REFLECTIVE STRIPING ACROSS FACE OF BUMPER	1
12VDC ELECTRICAL SYSTEM		1
50-00-0410	ELECTRICAL SYSTEM - V-MUX MULTIPLEX	1
50-05-0000	AMP DRAW REPORT - NFPA 1901, Section 9-15	1
50-10-0012	CAB CONSOLE - FLOOR MOUNT - FORD F-550 - VISIONMUX/V-MUX	1
50-20-0200	BRACKET- HAVIS-SHIELDS SIREN FOR WHELEN 295-Series	1
50-40-0110	CLEARANCE LIGHTS, LED & REFLECTORS W/CENTER REAR THIRD BRAKE	1
50-50-0200	TAIL LIGHT ASSY - LED STOP/TURN/BACKUP with CHROME BEZELS	1
51-10-1810	SCENE LIGHT - SIDE - WHELEN M9 LED OPTI-SCENE (EA)	4
51-10-2850	SCENE LIGHT - REAR - WHELEN M9 LED OPTI-SCENE (EA)	2
51-11-0100	SCENE LIGHT - REAR REVERSE ACTIVATED - V-MUX	1
51-11-0110	SCENE LIGHT - REAR REVERSE ACTIVATED - VISIONMUX	1
51-19-0110	GROUND LIGHTS - TECNIQ LED - UNDERBODY MOUNTED (EA)	5
51-50-1810	COMPARTMENT LIGHTS - LED STRIP - 24" RECESSED	5
51-50-1850	COMPARTMENT LIGHTS - LED STRIP - 42" RECESSED	2
51-55-1000	COMP'T OPEN WARNING & AUTO ACTIVATION - V-MUX	1
51-55-2000	COMP'T OPEN WARNING BUZZER	1
51-56-0100	COMP'T OPEN WARNING LIGHT - LED	1
NFPA 1901 WARNING LIGHTS		1

PART NO	DESCRIPTION	QTY
UPPER ZONE A - FRONT CAB WARNING LIGHTS		1
54-01-1556	WHELEN JUSTICE JE2NFPA - 56" LIGHT BAR - V-END Configuration	1
54-01-9902	BRACKET, LIGHTBAR CAB ROOF MOUNTING -Whelen	1
LOWER ZONE A - FRONT CAB WARNING LIGHTS		1
54-10-M7RC	WHELEN M7R RED SUPER-LED - CLEAR W/M7FC CHROME BEZEL (ea)	2
54-11-N018	LIGHT HOUSING - GRILLE - '17 F-550 - WHELEN 700 SERIES (PR)	1
LOWER ZONE B/D - CAB INTERSECTION WARNING LIGHTS		1
54-20-05RC	WHELEN 50R02ZCR RED SUPER-LED - CLEAR LENS W/5TSMAC CHROME BEZEL (ea)	1
54-20-PD02	LIGHT HOUSING - INTERSECTION - F-550 - WHELEN 500 SERIES TIR6 (PR)	1
LOWER ZONE B/D - SIDE BODY WARNING LIGHTS		1
54-21-M7RR	WHELEN M7R RED SUPER-LED - RED W/M7FC CHROME BEZEL (ea)	2
LOWER ZONE C - REAR BODY WARNING LIGHTS		1
54-25-M6RC	WHELEN M6RC RED SUPER-LED - CLEAR W/M4FC CHROME BEZEL (ea)	2
UPPER ZONE B/D - SIDE BODY WARNING LIGHTS		1
54-30-M9RC	WHELEN M9RC RED SUPER-LED - CLEAR W/M9FC CHROME BEZEL (ea)	4
UPPER ZONE C - REAR BODY WARNING LIGHTS		1
54-31-M9RC	WHELEN M9RC RED SUPER-LED - CLEAR W/M9FC CHROME BEZEL (ea)	2
54-99-0000	NFPA LIGHTING CERTIFICATION	1
AUDIBLE WARNING DEVICES		1
55-22-1000	SIREN - WHELEN ELECTRONIC - 295SLSA1	1
55-30-1000	HORN/SIREN SWITCH	1
55-41-5001	SPEAKER, SIREN - F-550 - CPI THRU-THE-BUMPER (DRIVER - 2017)	1
58-50-1000	12VDC POWER STRIP - (6) TERMINALS - CAB	1
58-80-1000	BACK-UP ALARM - FEDERAL 210333	1
58-82-0000	REARVIEW COLOR CAMERA W/NIGHTVISION & MONITOR - Visionmux	1
58-82-0125	REARVIEW MIRROR MOUNTING ARM for MONITOR	1
59-59-0000	ANTENNA COAXIAL W/CONNECTOR - MOTOROLA 17'	1
120/240VAC ELECTRICAL SYSTEM		1
89-99-9600	DOT SAFETY KIT	1
ADMINISTRATIVE - FIXED		1
98-01-1000	MANUAL, HACKNEY OWNERS W/SCHEMATICS	1
98-10-1500	PRE-DELIVERY CLEAN-UP - CAB & BODY	1
98-11-1000	FUEL TANK FULL AT FACTORY DELIVERY (up to 50-gallon tank)	1
99-99-9999	SHOP ORDER APPROVAL	1

ORIGINAL

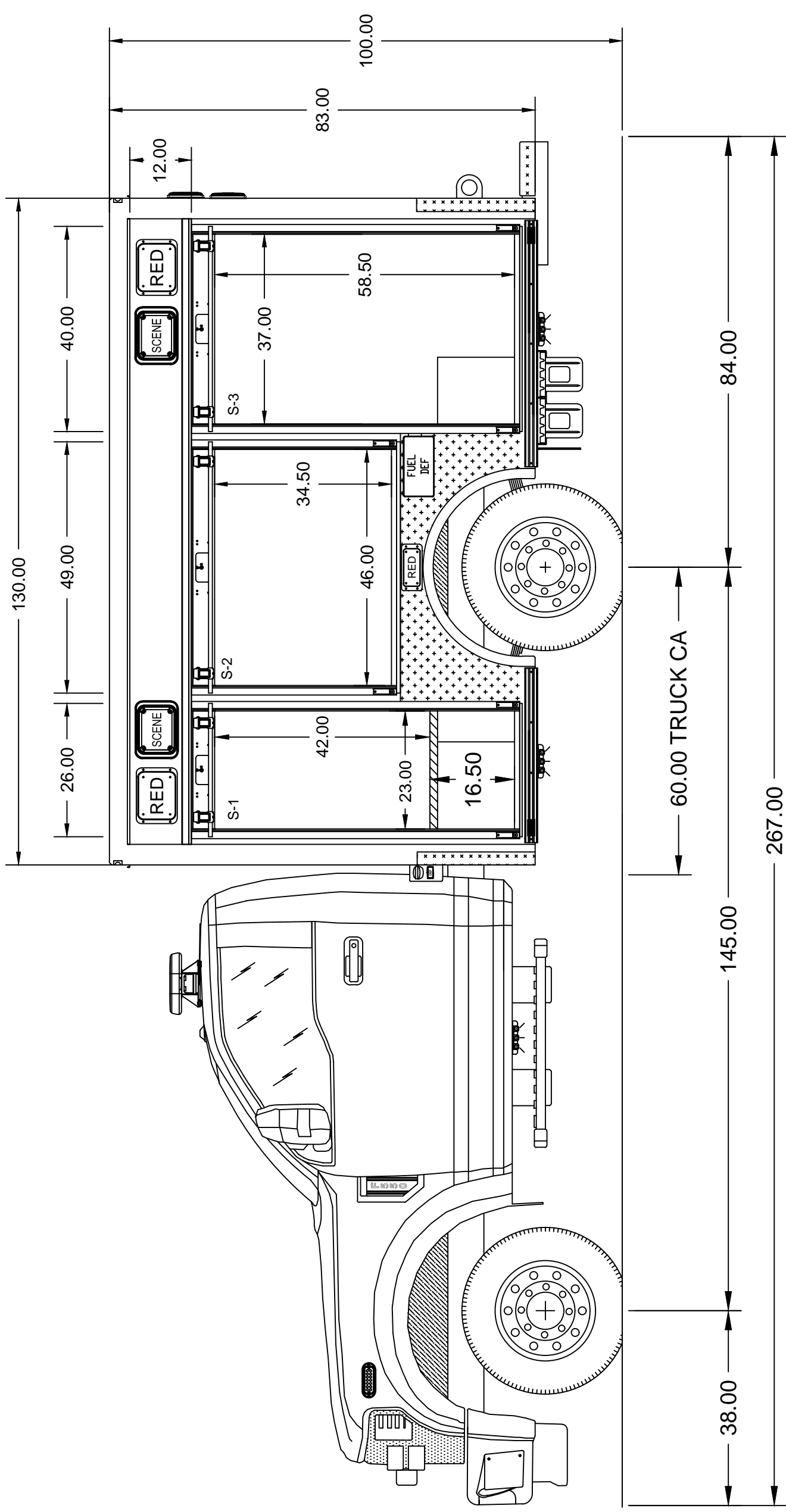

STREETSIDE EXTERIOR

THIS PRINT AND ALL RIGHTS TO THE DESIGN AND DETAIL THEREON ARE THE PROPERTY OF VT HACKNEY AND IS LOANED TO THE RECIPIENT SUBJECT TO RETURN UPON DEMAND. ITS CONTENTS ARE CONFIDENTIAL AND MUST NOT BE COPIED OR SUBMITTED TO OUTSIDE PARTIES FOR USE OR EXAMINATION. COPYRIGHT 2010 VT HACKNEY A COMPANY OF VT SYSTEMS

VT Hackney
A company of VT Systems
WASHINGTON, NC 27889-0880

Hackney
Kaltron

VisionComms

NJPA

CONTRACT NO.

CUSTOM DESIGN FOR

DRAWN BY EES DATE 02/01/18 SHEET 2 OF 3

© 2010 VT HACKNEY INC

NOTE: ESTIMATED DIMENSIONS. MEASUREMENTS DEPEND ON CHASSIS, TIRES, SPRINGS, AND LOADING.

DRAWING NO.

SCALE 18

MODEL LRC0-0758-60

REV.

ORIGINAL

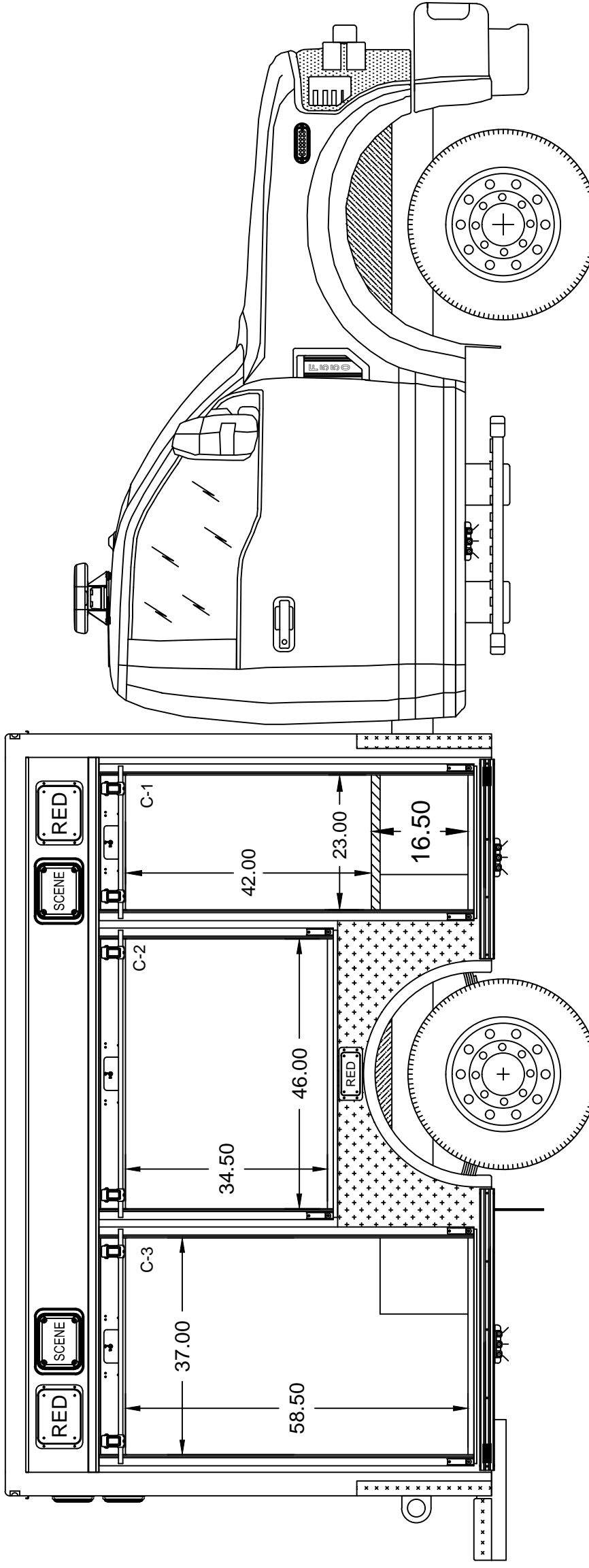

CURBSIDE EXTERIOR

THIS PRINT AND ALL RIGHTS TO THE DESIGN AND DETAIL THEREON ARE THE PROPERTY OF VT HACKNEY AND IS LOANED TO THE RECIPIENT SUBJECT TO RETURN UPON DEMAND. ITS CONTENTS ARE CONFIDENTIAL AND MUST NOT BE COPIED OR SUBMITTED TO OUTSIDE PARTIES FOR USE OR EXAMINATION. COPYRIGHT 2010 VT HACKNEY A COMPANY OF VT SYSTEMS



WASHINGTON, NC 27889-0880
A company of VT Systems

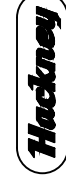

VisionComms

CUSTOM DESIGN FOR NJPA

CONTRACT NO.

DRAWN BY EES DATE 02/01/18 SHEET 1 OF 3

MODEL: LRC0-0758-60 SCALE 18

NOTE: ESTIMATED DIMENSIONS. MEASUREMENTS DEPEND ON CHASSIS, TIRES, SPRINGS, AND LOADING.

© 2010 VT HACKNEY INC

REV.



ORIGINAL

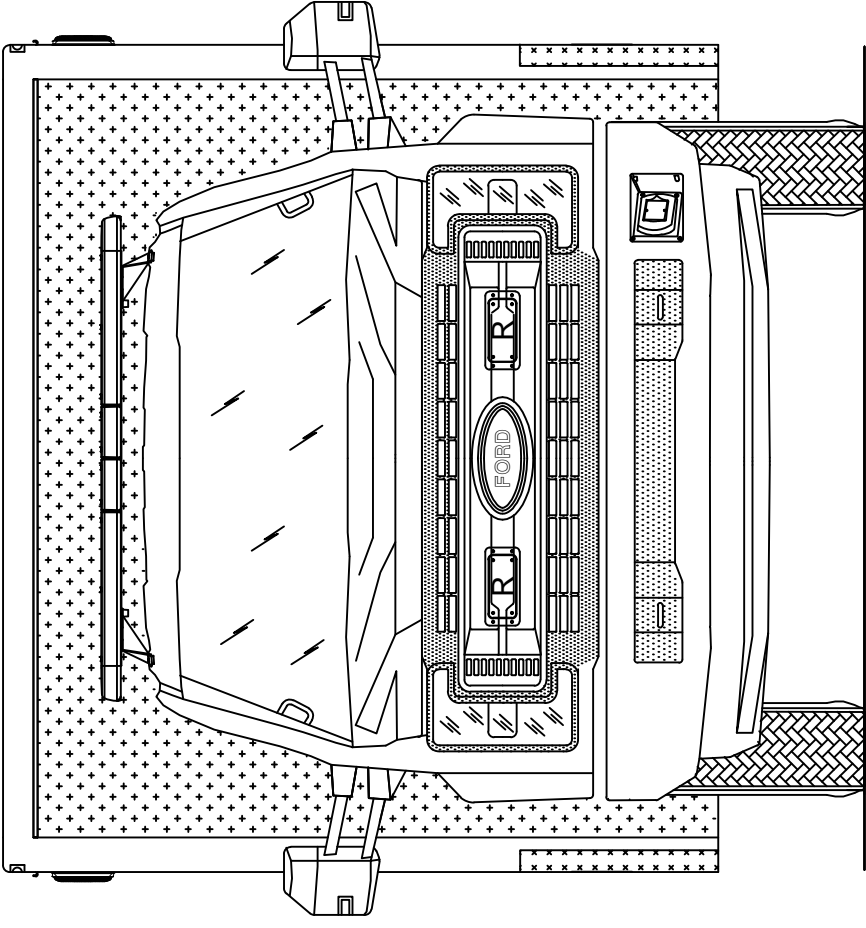
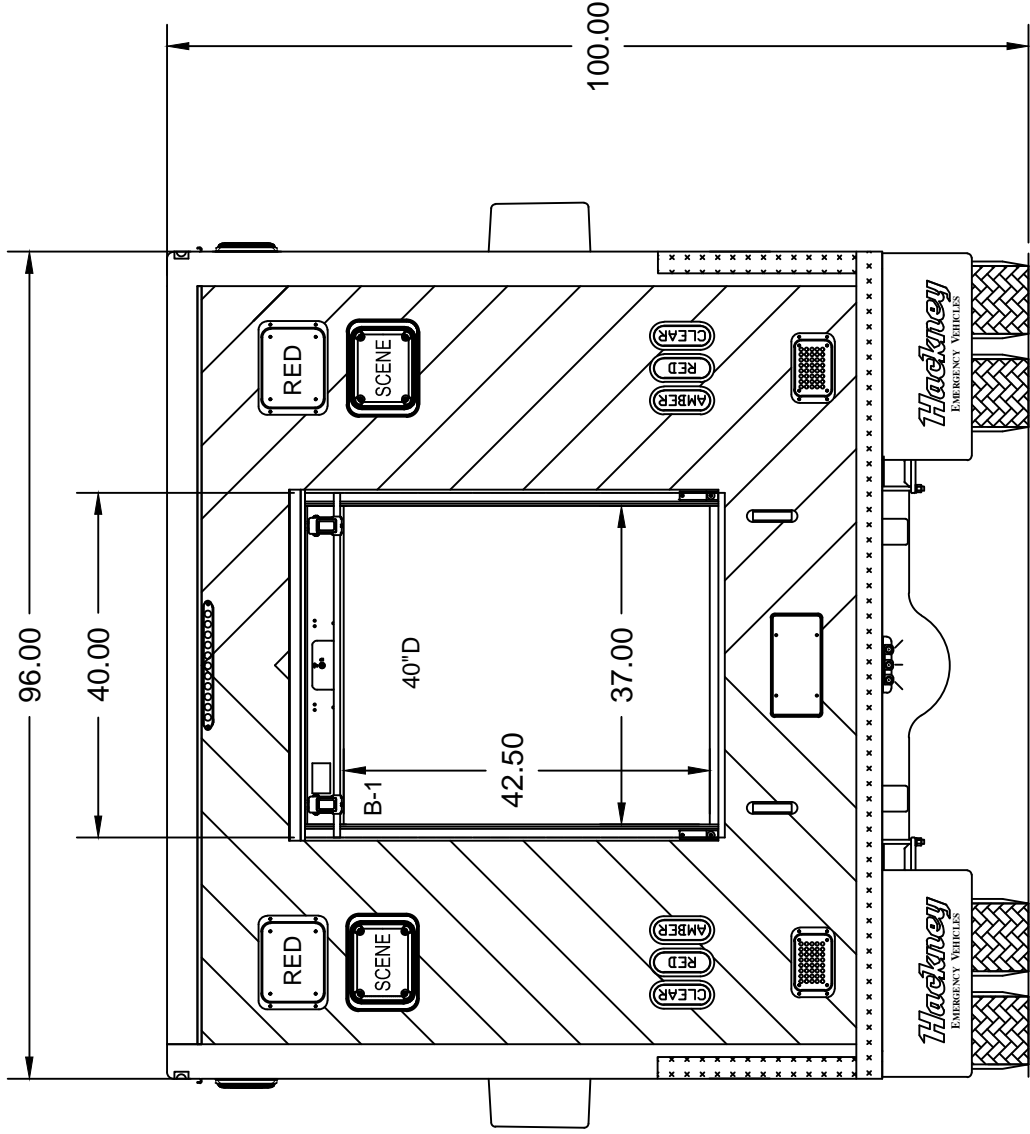

THIS PRINT AND ALL RIGHTS TO THE DESIGN AND DETAIL THEREON ARE THE PROPERTY OF VT HACKNEY AND IS LOANED TO THE RECIPIENT SUBJECT TO RETURN UPON DEMAND. ITS CONTENTS ARE CONFIDENTIAL AND MUST NOT BE COPIED OR SUBMITTED TO OUTSIDE PARTIES FOR USE OR EXAMINATION. COPYRIGHT 2010 VT HACKNEY A COMPANY OF VT SYSTEMS

© 2010 VT HACKNEY INC
 NOTE: ESTIMATED DIMENSIONS.
 MEASUREMENTS DEPEND ON CHASSIS,
 TIRES, SPRINGS, AND LOADING.

VT Hackney
 A company of VT Systems
 WASHINGTON, NC 27889-0880

Hackney
VisionComms
 CUSTOM DESIGN FOR:
NJPA
CONTRACT NO.
 DRAWING NO. **18**
 SCALE

DRAWN BY: **EES**
 DATE: **02/01/18**
 SHEET: **3 OF 3**

MODEL: **LRC0-0758-60**

REV.