



VT Hackney

A company of VT Systems



Model TDD1387 Heavy Rescue Trailer

Hackney

Sourcewell 
Formerly NJPA

Awarded Contract

Contract # 022818-VTH

TDD-1387

Hackney Emergency Vehicles

NJPA - HACKNEY TDD1387 - DROP DECK TRAILER

Sales Rep:

Terms:

Drawing #:

Est. Delivery Date: / /

Customer PO #:

Penalty:

Customer #:

QPF #:

Exp. Date: 03/10/2018

Quote No: 10032-0002

BODY: XTDD100 NJPA TDD1387 TRAILER - DROP DECK

08/17/2018

Page 1

PART NO	DESCRIPTION	QTY
== NJPA TDD1387 TRAILER - DROP DECK ==		1
== QW RELEASE - Effective 01-02-18 ==		1
CAB and CHASSIS		1
10-02-1800	FREIGHTLINER M2-112 - TRACTOR - 2-DR CUMMINS L9 - 350HP	1
10-19-1018	VDR Supplied with Chassis (Freightliner only)	1
10-19-1025	"MUST BE SEATED AND BELTED" - WARNING PLATE	1
10-19-1045	WARNING PLATE - VEHICLE SPECIFICATION DATA	1
10-19-1075	"DO NOT WEAR HELMET WHILE SEATED" - WARNING PLATE	1
10-99-1600	EXHAUST, VERTICAL STACK - OEM INSTALLED	1
11-16-0220	BATTERY CONDITIONER - PROGRESSIVE DYNAMICS	1
11-17-0020	SHOREPOWER INLET, 20 AMP W/COVER & FEMALE PLU	1
11-17-0201	COVER - 20-AMP - KUSSMAUL YELLOW	1
11-31-5006	ENGINE COMP'T LIGHT - Centered on Firewall	1
11-33-0802	GROUND LIGHTS - TECNIQ LED - FRONT CAB DOOR (PR)	1
12-00-1010	MUD FLAPS - RE-INSTALL CHASSIS OEM	1
12-11-1000	FUEL TANK COVER/STEP - FREIGHTLINER - 2-DR	1
12-11-1900	ULTRA-LOW SULFUR DIESEL FUEL ONLY LABEL	1
12-11-1950	DEF FLUID LABEL	1
12-13-0000	TRACTOR REAR FRAME ENCLOSURE & STEPS	1
12-57-0022	TIRE PRESSURE MONITORING - REALWHEELS AIRSECURE - 10-WHL	1
BODY and FRAME OPTIONS		1
20-09-0110	TRAILER & FRAME - TANDEM AXLES - BID FORMAT	1
20-19-0400	TRAILER BODY - TDD13877 - DROP DECK	1
20-49-9000	OVERALL HEIGHT PLATE	1

PART NO	DESCRIPTION	QTY
20-51-0110	ROOF, BRIGHT ALUMINUM TREADPLATE - STD PATTERN	1
20-61-0200	ROLLERS, STAINLESS STEEL ROLL-UP DOOR - ILOS - (Ea. Comp't Door)	12
20-70-0110	DOOR, SIDE PERSONNEL ENTRANCE - up to 83" H	1
20-70-0150	WINDOW, DOOR - 30"H X 18"W - SLIDING - black painted or clear anodized frame (EA)	1
20-71-0320	FENDERETTES, STAINLESS STEEL (PR)	2
21-01-1502	INTERIOR WALLS, CEILING & INSULATION - WHITE FRP -15-ft	1
EXTERIOR BODY OPTIONS		1
22-21-0000	STONE GUARDS, FRT & REAR - D/P CORNERS (4)	1
22-25-2000	BUMPER, REAR STEP BRIGHT TREAD PLATE	1
22-31-3500	STEP, DROP DOWN FOR TRAILER (EA)	4
22-40-0100	HOLDER FOR WHEEL CHOCK - ZICO SQCH-44 (EA)	2
22-40-2000	WHEEL CHOCK - ZICO AC-44 (EA)	2
22-50-3010	LICENSE PLATE INSERTS & LIGHT	1
22-51-1000	MUD FLAPS, REAR (PR) BLACK RUBBER	1
INTERIOR BODY OPTIONS		1
23-11-0506	UNISTRUT "C" CHANNEL (set of 4) - up to 50"L	4
23-11-0507	UNISTRUT "C" CHANNEL (set of 4) - Up to 70"L	8
23-11-0550	RECESSED ADJUSTABLE SHELF TRACK (EA)	1
EXTERIOR BODY OPTIONS		1
PAINT and GRAPHICS		1
40-00-0200	PAINT TRAILER - PRIMARY COLOR	1
42-12-0000	TOUCH UP PAINT - ONE QUART	1
42-90-0500	COMPARTMENT WALLS/FLOORS COATING - MULTISPEC (ea. comp't)	12
42-99-0010	UNDERCOATING CAB, TRAILER FRAME & BODY	1
43-20-2000	STRIPE, REFLECTIVE 4" PRICE PER FOOT REQS DWG	80
43-20-8035	CHEVRON STRIPE - REAR TRAILER BODY W/HINGED REAR DOOR - HEAVY RESCUE	1
43-20-8120	REFLECTIVE STRIPING ACROSS FACE OF BUMPER	1
12VDC ELECTRICAL SYSTEM		1
50-00-1310	ELECTRICAL SYSTEM - V-MUX - TRACTOR APP.	1
50-05-0000	AMP DRAW REPORT - NFPA 1901, Section 9-15	1
50-06-1110	SAFETY INTERLOCK SYSTEM - MED/HD CHASSIS	1
50-10-0100	CAB CONSOLE - FLOOR MOUNT - INTERNATIONAL/FREIGHTLINER - VISIONMUX/V-MUX	1
50-40-0200	CLEARANCE LIGHTS, LED & REFLECTORS - TRAILER	1
50-50-0200	TAIL LIGHT ASSY - LED STOP/TURN/BACKUP with CHROME BEZELS	1
50-50-4000	STOP LIGHT, LED AUXILIARY UPPER (PR)	1
50-51-9000	AUXILIARY LED TURN SIGNALS - AMBER, CENTER BODY	1
51-10-1725	SCENE LIGHT - SIDE - WHELEN 90 LED OPTI-SCENE (EA)	4
51-10-2515	SCENE LIGHT - REAR - WHELEN 90 LED OPTI-SCENE (EA)	2
51-19-0110	GROUND LIGHTS - TECNIQ LED - UNDERBODY MOUNTED (EA)	6
51-19-0130	GROUND LIGHTS ACTIVATED BY TURN SIGNALS /REVERSE	1
51-50-1810	COMPARTMENT LIGHTS - LED STRIP - 24" RECESSED	4
51-50-1850	COMPARTMENT LIGHTS - LED STRIP - 42" RECESSED	8
51-55-1000	COMP'T OPEN WARNING & AUTO ACTIVATION - V-MUX	1
51-55-2000	COMP'T OPEN WARNING BUZZER	1
51-56-0100	COMP'T OPEN WARNING LIGHT - LED	1

PART NO	DESCRIPTION	QTY
NFPA 1901 WARNING LIGHTS		1
UPPER ZONE A - FRONT CAB WARNING LIGHTS		1
54-01-1556	WHELEN JUSTICE JE2NFPA - 56" LIGHT BAR - V-END Configuration	1
LOWER ZONE A - FRONT CAB WARNING LIGHTS		1
54-10-07RC	WHELEN C7LRC RED SURFACEMAX - CLEAR LENS W/C7FC CHROMED BEZEL (ea)	2
54-15-5000	HEADLIGHT WIG-WAG PATTERN - V-MUX	1
LOWER ZONE B/D - CAB INTERSECTION WARNING LIGHTS		1
54-20-05RC	WHELEN 50R02ZCR RED SUPER-LED - CLEAR LENS W/5TSMAC CHROME BEZEL (ea)	2
LOWER ZONE B/D - SIDE BODY WARNING LIGHTS		1
54-21-06RC	WHELEN C6LRC RED SURFACEMAX - CLEAR LENS W/C6FC CHROMED BEZEL (ea)	6
LOWER ZONE C - REAR BODY WARNING LIGHTS		1
54-25-06RC	WHELEN C6LRC RED SURFACEMAX - CLEAR LENS W/C6FC CHROMED BEZEL (ea)	2
UPPER ZONE B/D - SIDE BODY WARNING LIGHTS		1
54-30-09RC	WHELEN C9LRC RED SURFACEMAX - CLEAR LENS W/C9FC CHROMED BEZEL (ea)	4
UPPER ZONE C - REAR BODY WARNING LIGHTS		1
54-31-09RC	WHELEN C9LRC RED SURFACEMAX - CLEAR LENS W/C9FC CHROMED BEZEL (ea)	2
AUDIBLE WARNING DEVICES		1
55-30-1000	HORN/SIREN SWITCH	1
58-50-1000	12VDC POWER STRIP - (6) TERMINALS - CAB	1
58-80-1000	BACK-UP ALARM - FEDERAL 210333	1
58-82-0030	REARVIEW COLOR CAMERA W/NIGHTVISION - TRAILER	1
59-59-0000	ANTENNA COAXIAL W/CONNECTOR - MOTOROLA 17'	1
MISCELLANEOUS EQUIPMENT		1
89-99-9600	DOT SAFETY KIT	1
ADMINISTRATIVE - FIXED		1
98-01-1000	MANUAL, HACKNEY OWNERS W/SCHEMATICS	1
98-10-1510	PRE-DELIVERY CLEAN-UP - TRACTOR & TRAILER	1
98-11-1000	FUEL TANK FULL AT FACTORY DELIVERY (up to 50-gallon tank)	1
99-99-9998	TEST DRIVE & INSURANCE REQUIREMENTS	1
99-99-9999	SHOP ORDER APPROVAL	1

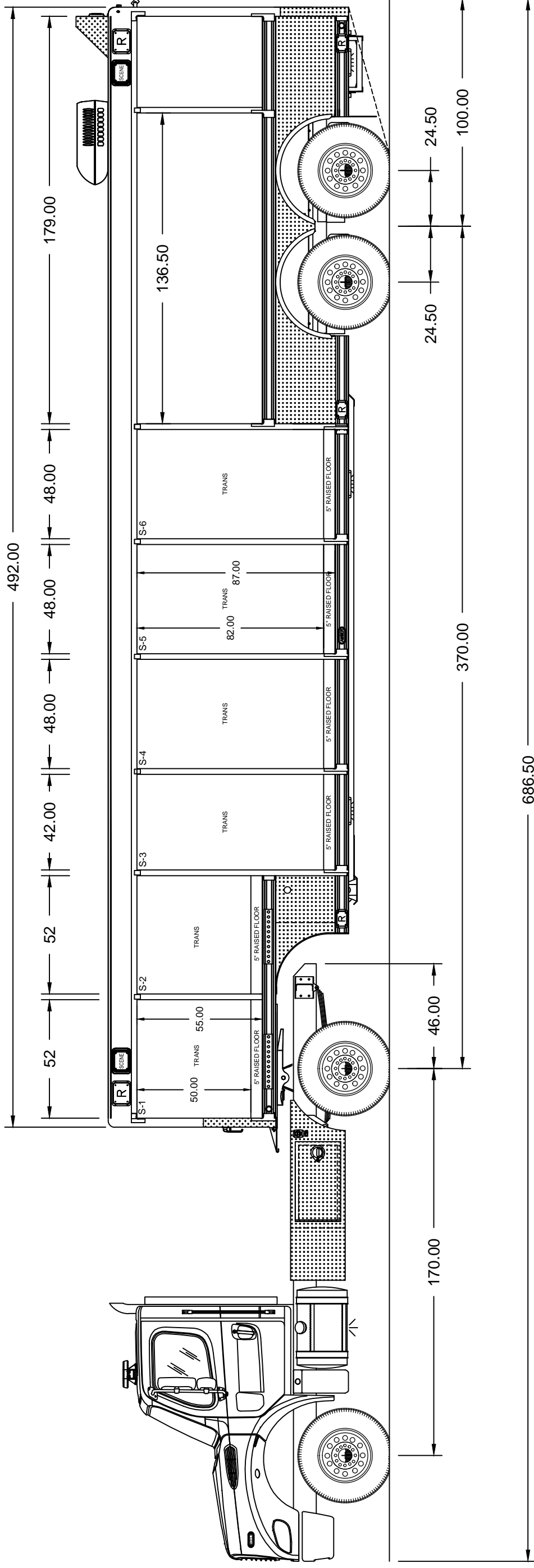

STREETSIDE EXTERIOR

THIS PRINT AND ALL RIGHTS TO THE DESIGN AND DETAIL THEREON ARE THE PROPERTY OF VT HACKNEY AND IS LOANED TO THE RECIPIENT SUBJECT TO RETURN UPON DEMAND. ITS CONTENTS ARE CONFIDENTIAL AND MUST NOT BE COPIED OR SUBMITTED TO OUTSIDE PARTIES FOR USE OR EXAMINATION. COPYRIGHT 2015 VT HACKNEY A COMPANY OF VT SYSTEMS

VT Hackney
A company of VT Systems
WASHINGTON, NC 27889-0880



DRAWN BY EES		DATE 02/01/18	CUSTOM DESIGN FOR NJPA	
SHEET 2 OF 4		CONTRACT #		0000
MODEL TDD-1387-RRD		SCALE 45	DRAWING NO.	
				REV. -

© 2015 VT HACKNEY INC

NOTE: ESTIMATED DIMENSIONS.
MEASUREMENTS DEPEND ON CHASSIS,
TIRES, SPRINGS, AND LOADING.

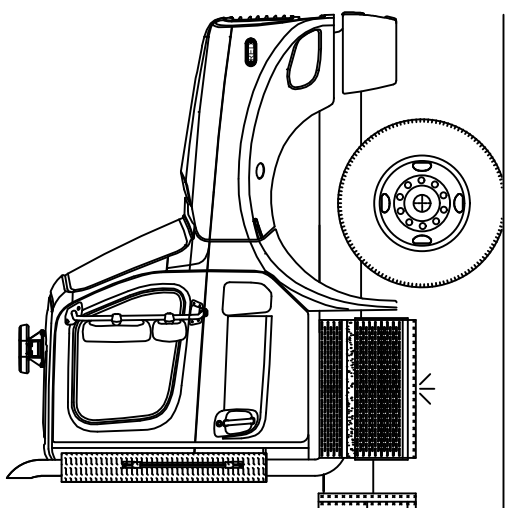
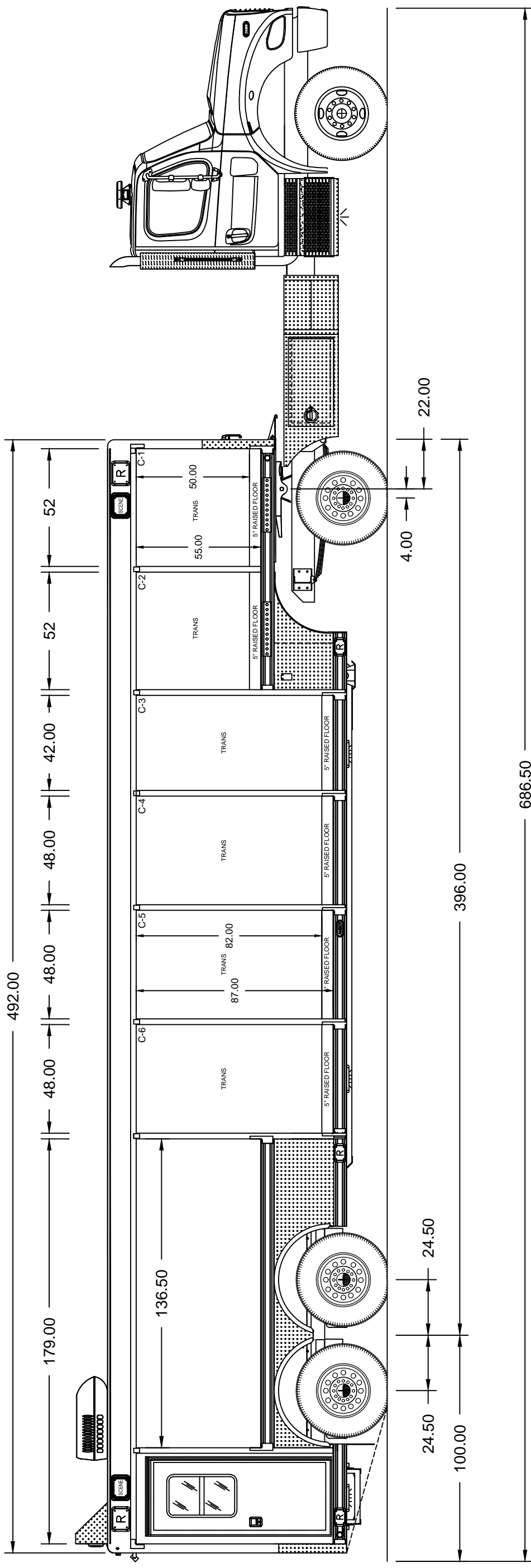

CURBSIDE EXTERIOR

THIS PRINT AND ALL RIGHTS TO THE DESIGN AND DETAIL THEREON ARE THE PROPERTY OF VT HACKNEY AND IS LOANED TO THE RECIPIENT SUBJECT TO RETURN UPON DEMAND. ITS CONTENTS ARE CONFIDENTIAL AND MUST NOT BE COPIED OR SUBMITTED TO OUTSIDE PARTIES FOR USE OR EXAMINATION. COPYRIGHT 2015 VT HACKNEY A COMPANY OF VT SYSTEMS

VT Hackney
A company of VT Systems
WASHINGTON, NC 27889-0880



DRAWN BY EES		DATE 2/1/18	CUSTOM DESIGN FOR NJPA	
SHEET 1 OF 4		CONTRACT #		0000
MODEL TDD-1387-RRD		SCALE 45	DRAWING NO.	
				REV. -

© 2015 VT HACKNEY INC

NOTE: ESTIMATED DIMENSIONS.
MEASUREMENTS DEPEND ON CHASSIS,
TIRES, SPRINGS, AND LOADING.

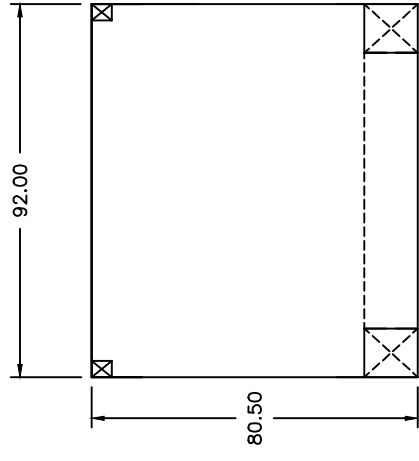

AFT ROOM VIEW

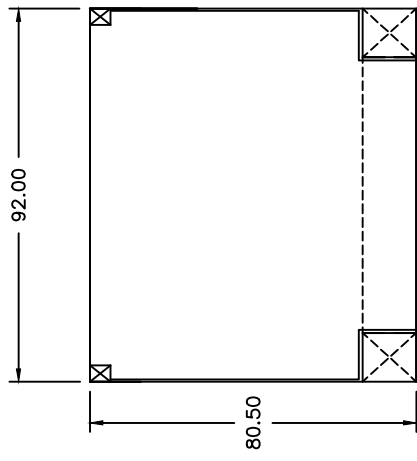

FORWARD ROOM VIEW

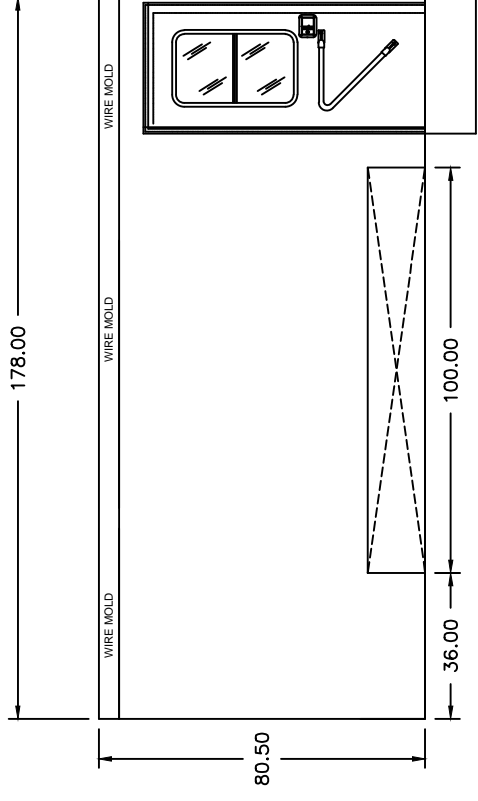

CURBSIDE WALL

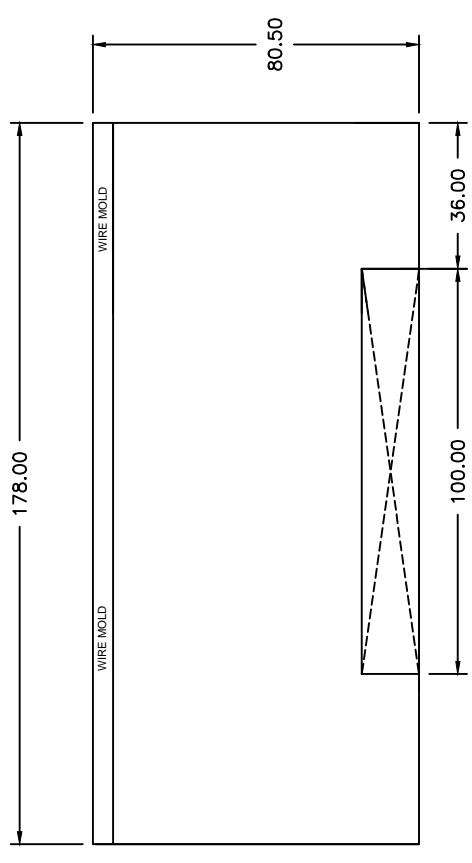

STREETSIDE WALL

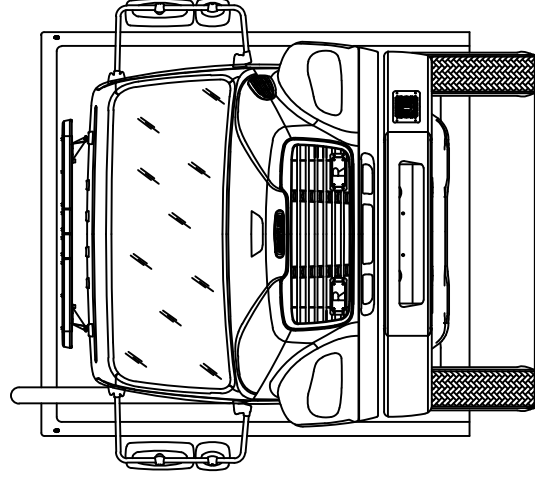

FRONT

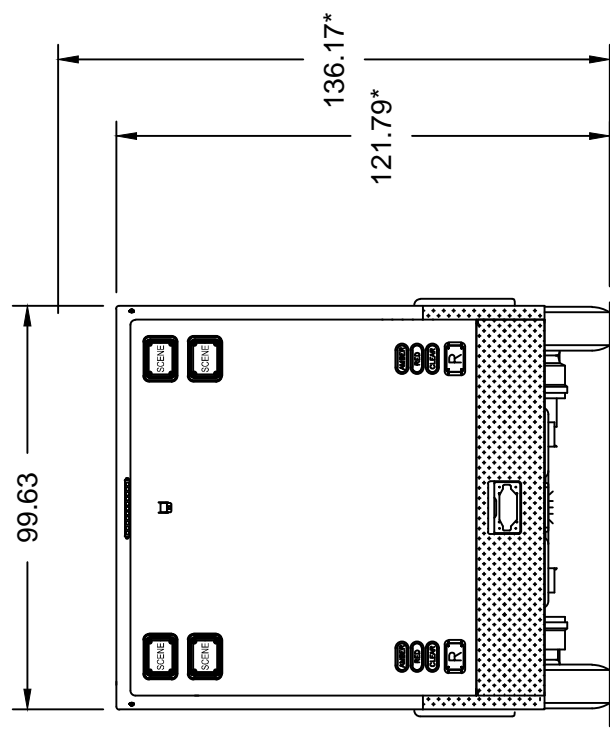

REAR WALL

THIS PRINT AND ALL RIGHTS TO THE DESIGN AND DETAIL THEREON ARE THE PROPERTY OF VT HACKNEY AND IS LOANED TO THE RECIPIENT SUBJECT TO RETURN UPON DEMAND. ITS CONTENTS ARE CONFIDENTIAL AND MUST NOT BE COPIED OR SUBMITTED TO OUTSIDE PARTIES FOR USE OR EXAMINATION. COPYRIGHT 2015 VT HACKNEY A COMPANY OF VT SYSTEMS

© 2015 VT HACKNEY INC

NOTE: ESTIMATED DIMENSIONS.
MEASUREMENTS DEPEND ON CHASSIS,
TIRES, SPRINGS, AND LOADING.



A company of VT Systems
WASHINGTON, NC 27889-0880

DRAWN BY EES DATE 8/9/17

SHEET 1 OF 1

CUSTOM DESIGN FOR NJPA

CONTRACT #

MODEL: TDD-1387-RRD SCALE 45

DRAWING NO. 0000

REV. -

